

ANGUS

MOUNTING INSTRUCTIONS

Included in the package:

- Angus unit (For units that have an attached permanent secondary unit, instructions continue on the reverse side.)
- Drill template
- Hardware kit

Tools required:

- Pencil
- Philips Head screwdriver
- Drill
- 1/8" drill Bit

1. Determine the desired location for the Angus unit underneath the worksurface. Note that Angus must be placed at a minimum depth of 4" from the back edge (**Fig. 1**).
2. Using a pencil, trace inside each of the four mounting holes onto the mounting surface. Remove unit and drill pilot holes at the locations just marked. (**Fig. 2**).
3. Align Angus unit with the pilot holes, making sure to orient the unit with the power switch facing the end user. Secure in place using the provided screws (**Fig. 3**).
4. Plug in the unit into an AC wall outlet. **Note: Do not plug Angus into a power strip or extension cord.**
5. Power Angus by turning on the switch. When the unit is "ON", the power switch will be lit.

FCC COMPLIANCE

This device complies with Part 15 of the FCC Rules. Operation is subject to the following two conditions: (1) This device may not cause harmful interference, and (2) this device must accept any interference received, including interference that may cause undesired operation. This Class A digital apparatus complies with Canadian ICES-003.

Cet appareil numérisé de la classe A est conforme à la norme NMB-003 du Canada.

Fig. 1

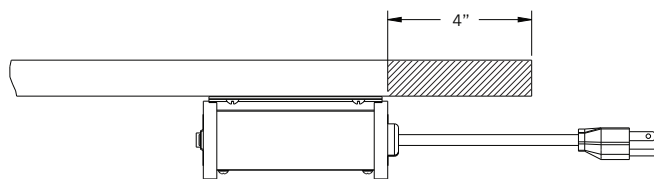

Fig. 2

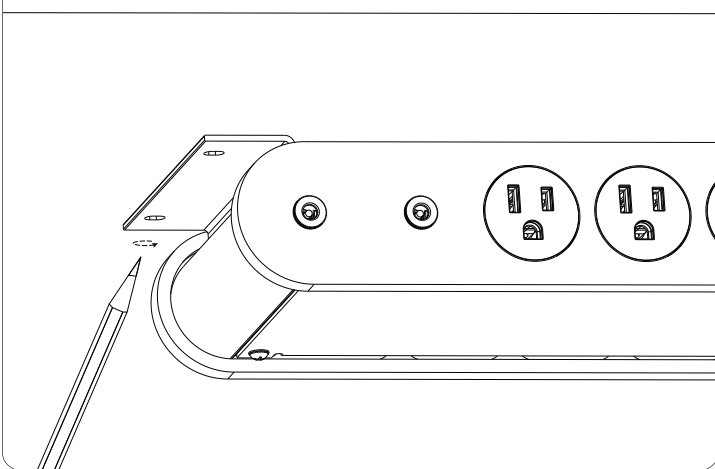
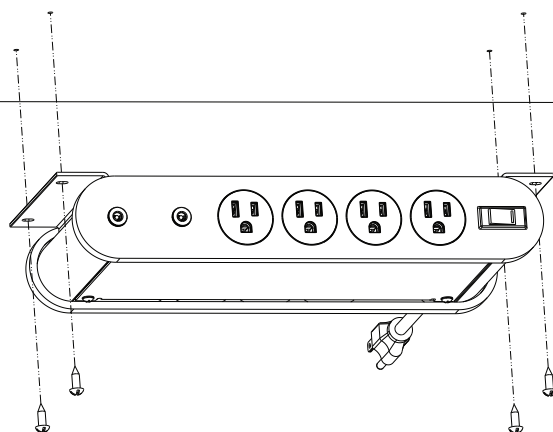

Fig. 3



ANGUS WITH PERMANENT SECONDARY UNIT

MOUNTING INSTRUCTIONS

Included in the package:

- Angus with permanent secondary unit
- Hardware kit
- Nik mount
- Nik mounting hardware

Tools required:

- Pencil
- Philips Head screwdriver
- Drill
- 1/8" drill Bit

1. Install the Angus unit per the instructions on the reverse side. To install Nik, follow the instructions below, respective to how Nik will be mounted:

CLAMP MOUNT:

1. Slide unit mount onto edge of surface (**Fig. 4**).
2. Tighten thumbscrews on the underside of the surface (**Fig. 5**).

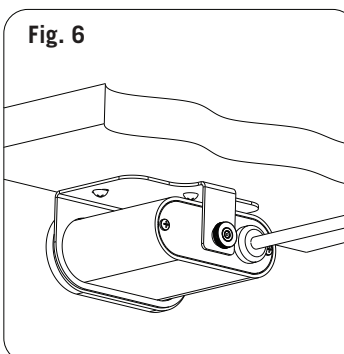
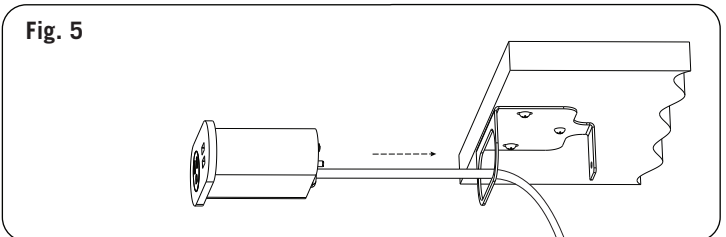
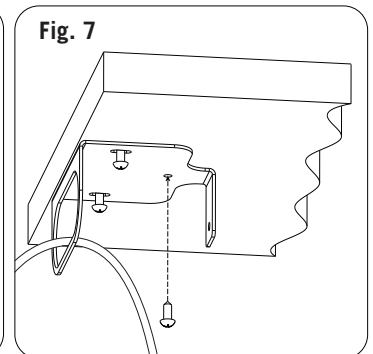
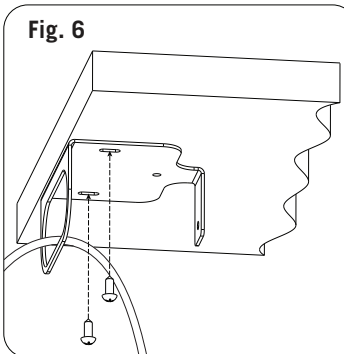
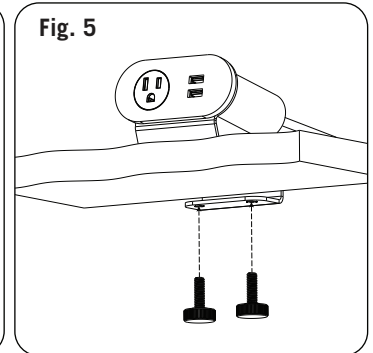
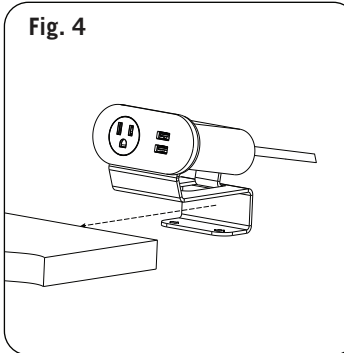

UNDERSURFACE MOUNT:

1. Locate mounting bracket where desired and place a small mark in each slot. Remove bracket.
2. Using the pilot drill bit, drill a hole on each mark that is 1/2" deep.
3. Attach mounting bracket to the underside of the surface utilizing the two slotted holes (**Fig. 6**). Do not fully tighten screws.
4. Align bracket to final desired position and drive the third screw thru the remaining hole (**Fig. 7**). Tighten all screws.
5. Feed unit thru the mounting bracket making sure to pass the threaded stud thru the hole in the back of the bracket (**Fig. 8**).
6. Fix the unit in place with the provided thumb nut (**Fig. 9**).