

Desk Light

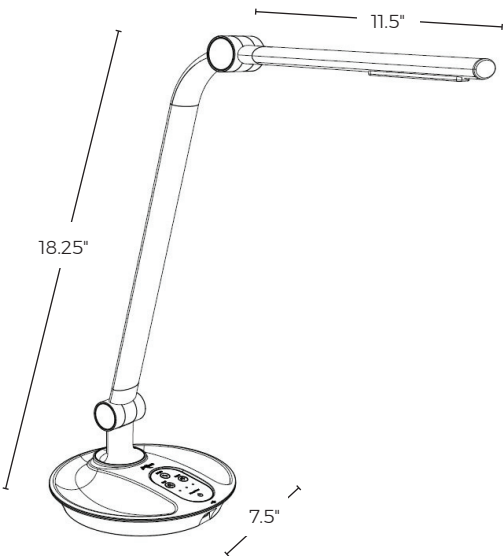

paper

L / G H T C O R P



FEATURES:

- Selectable color temperature
- Programmable shut-off timer after 50 minutes
- USB charging
- 3-step dimming

DIMENSIONS:

	W	H	D
PIPER	7.5"	18.25"	18.5"

SPECIFICATIONS:

ENERGY CONSUMPTION	9.5 system watts
NUMBER OF LEDs	36 fractional LEDs
LIGHT OUTPUT	511 lumens
LED RATED LIFESPAN	> 50,000 hours
COLOR TEMPERATURES	2700K/4500K/6000K
COLOR RENDERING INDEX	82
BRIGHTNESS ADJUSTABILITY	100%/63%/30%; 3-step
USB CHARGE PORT	Type-A connector, 5V; 1.2A max
POWER SUPPLY	16-watt wall transformer with 4' 11" white cord
MATERIALITY	aluminum and plastic
CERTIFICATIONS	ETL listed: compliant to UL 153 & CSA C22.2 No. 250.4; FCC Part 15 Class B; TAA
WARRANTY	3 years, excludes power supply

SUSTAINABILITY NOTES:

- Made with fully-recyclable aluminum and plastic. Please contact your local county or municipality to determine your local recycling options.
- Energy-saving features such as programmable shut-off and dimming included
- Lower power consumption
- Mercury-free
- Potential LEED points. For more LEED information please visit <https://new.usgbc.org/leed-v41>

MOUNTING:

Piper is available with a freestanding base.

FINISH:



PHOTOMETRIC DATA:

Footcandle outputs measured at 15" from the work surface at 6000K.

	18"	12"	6"	CL	6"	12"	18"
12"	10	20	34	43	34	19	9
6"	14	22	69	95	66	31	13
CL	16	40	92	130	87	37	15
6"	14	32	67	89	63	30	13
12"	9	19	33	45	31	18	9

SPECIFICATION NOTES:

- The arm has a 15" reach from the front of the base to the fixture head.
- Total weight of the fixture is 2.5 lbs.
- The cord extender accessory extends the total cord length to 7' 11" and is available in black only.
- This fixture is not field serviceable.